



## P 3000 Series

The P 3000 series is a new generation, high-performance flat-plate collector. Two connectors on the lateral edge and the possibility of installing them in portrait or landscape format makes all types of installation both quick and easy.

### Special performance features

- | High power output
- | Lightweight structured solar safety-glass
- | Harp-shaped absorber with highly selective coating
- | Increased thermal insulation (50 mm)
- | Flow direction reversible
- | Interconnection of up to 8 collectors in series
- | Landscape installation due to special P 3000 L collector

### Broad range of applications

- | Suitable for systems supporting drinking water and heating
- | Suitable for high-flow and low-flow operation
- | Especially suitable for large areas

### Easy to install

- | Easy installation due to the use of tried and tested fastener systems
- | Fast installation due to screwed-connection collector tubes

### First-class production quality

- | Hailstone-tested 4 mm solar safety-glass in accordance with ÖNORM (Austrian Standard) 12975-2
- | High performance collector with brown anodised aluminium frame profile
- | Recyclable construction
- | 100% component testing

### Certificates

- | Solar Keymark certified
- | Tested to ÖNORM (Austrian Standard) EN 12975-2
- | Meets conditions for grants by the Federal and Provincial Governments
- | CE mark
- | Meets all criteria of the Blue Angel (Blauer Engel)

P 3000

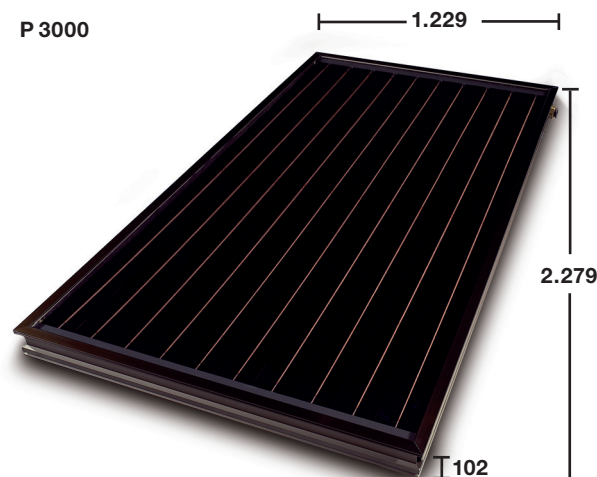

All dimensions in mm

Pressure loss of flat-plate collector P 3000

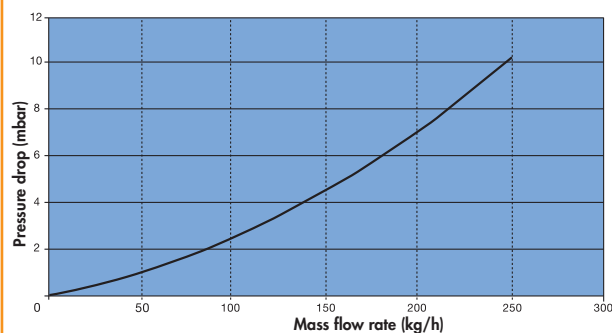



## P 3000 Series

### Overview

- A** Absorber
- B** Collector frame
- C** Rear wall insulation
- D** Glass panel
- E** Edge insulation

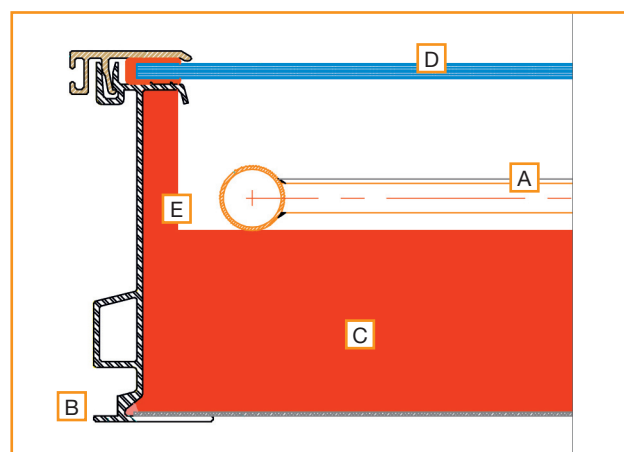

### Types of installation

#### On-roof parallel

#### P 3000



#### Portrait

Tiled roof, folded sheet metal roof, corrugated eternit roof, eternit panel roof, slate roof, trapezoidal sheet metal roof

#### P 3000 L



#### Landscape

Tiled roof, folded sheet metal roof, corrugated eternit roof, eternit panel roof, slate roof, trapezoidal sheet metal roof

### Elevation



#### Portrait

Tiled roof, folded sheet metal roof, corrugated eternit roof, eternit panel roof, slate roof, trapezoidal sheet metal roof, flat roof



#### Landscape

Tiled roof, folded sheet metal roof, corrugated eternit roof, eternit panel roof, slate roof, trapezoidal sheet metal roof, flat roof

	P 3000	P 3000 L
<b>Design</b>	Flat-plate collector portrait	Flat-plate collector landscape
<b>Dimensions (W x H x D)</b>	1,229 x 2,279 x 102 mm	2,279 x 1,229 x 102 mm
<b>Gross area</b>	2.80 m <sup>2</sup>	2.80 m <sup>2</sup>
<b>Aperture area</b>	2.57 m <sup>2</sup>	2.57 m <sup>2</sup>
<b>Weight</b>	54.85 kg	54.85 kg
<b>Max. permissible operating pressure</b>	6 bar	6 bar
<b>Collector content</b>	2.2 l	2.2 l
<b>Absorber type</b>	Fin, highly selective, blue, 2 serial tube sections each with 5 harp tubes	Fin, highly selective, blue, serial tube sections with 10 harp tubes
<b>Cover</b>	Solar safety-glass, 4 mm, lightly structured	Solar safety-glass, 4 mm, lightly structured
<b>Collector frame</b>	Aluminium frame profile, brown anodised	Aluminium frame profile, brown anodised
<b>Shutdown temperature</b>	219 °C	219 °C
<b>Connectors, diameters</b>	2 brass connectors, laterally at top on long side	2 brass connectors, laterally at top on short side.
<b>Collectors in series</b>	Max. 8	Max. 8

Available from:

Please contact us:  
Tel. +43 (0)4262 37855-0  
www.ripisol.at  
Subject to technical changes